

Starter Repair Kit Saves You Time and Money



Save Time - Order this kit and receive all the parts you need for a starter repair.

Save Money - And do it yourself. Call or go online and order yours today. Kit includes remanufactured starter drive, bushings, brushes, washers and snap ring.

PART	DESCRIPTION AND APPLICATION	REQD	LIST	SELL
36-1525	STARTER REPAIR KIT 6CYL BLZ JIM	73-87 (1)	21.19	16.95
36-1525	STARTER REPAIR KIT W/O DSL V8 BLZ JIM	73-81 (1)	21.19	16.95
36-1526	STARTER REPAIR KIT 2WD 305 BLZ JIM	82 (1)	21.19	16.95
36-1525	STARTER REPAIR KIT 4WD 305 BLZ JIM	82 (1)	21.19	16.95
36-1525	STARTER REPAIR KIT 305F BLZ JIM	83 (1)	21.19	16.95
36-1526	STARTER REPAIR KIT 2WD 305H BLZ JIM	83 (1)	21.19	16.95
36-1525	STARTER REPAIR KIT 4WD 305H BLZ JIM	83 (1)	21.19	16.95
36-1526	STARTER REPAIR KIT 305 BLZ JIM	84-85 (1)	21.19	16.95
36-1525	STARTER REPAIR KIT 305 BLZ JIM	86-87 (1)	21.19	16.95
36-1525	STARTER REPAIR KIT 350 454 BLZ JIM	82-91 (1)	21.19	16.95
36-1525	STARTER REPAIR KIT DSL BLZ JIM	78-79 (1)	21.19	16.95
36-1527	STARTER REPAIR KIT DSL BLZ JIM	80-88 (1)	33.69	26.95
36-1528	STARTER REPAIR KIT DSL BLZ JIM	89-91 (1)	62.44	49.95

Heated Windshield Washer Kit



Heat your vehicle's windshield washer fluid to a temperature of 125-135°F and allow for quick, effortless removal of frost, snow and ice this winter. Heated washer fluid extends the service life of windshield wipers by minimizing unnecessary wear and ensures wiper spray nozzles remain clog-free for a consistent spray pattern every time. Suited for year-round use, the heated washer fluid also provides improved cleaning to remove bird droppings, bugs, grime, road film and streaks.

The Heated Windshield Washer Kit installs inline between the windshield washer reservoir and spray nozzles. The wiring connects directly to your vehicle's battery with the included ground cable and fused power cable. The unit begins operation when it senses battery voltage higher than 13.0 volts (engine running). The initial heating cycle takes approximately 30 seconds for the washer fluid to reach 125-135°F. Each time the driver activates the vehicle's factory installed windshield washer system, heated washer fluid is applied during the first 3 seconds of spray time to deliver a 50-60cc spray volume. Each additional 3-second spray of heated washer fluid is available for use within 10-20 seconds.

Order yours today and see what a difference the Heated Windshield Washer Kit can make! Kit includes mounting bracket, hardware and instructions.

PART	DESCRIPTION AND APPLICATION	REQD	LIST	SELL
36-4085	HEATED WINDSHIELD WASHER KIT	(1)	124.94	99.95

Wiper Arm Tool

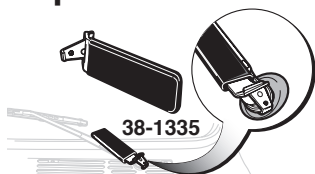

Wiper Arm Tool provides the leverage you need to safely remove and install wiper arms without damaging your vehicle.

Tech Tip: Make sure all locking pins or retaining nuts have been removed before using the Wiper Arm Tool.

38-1335	WIPER ARM TOOL	(1)	6.19	4.95
---------	----------------	-----	------	------

Starter, Solenoid and Heat Shield

Blazer 1973-91
Jimmy 1973-91

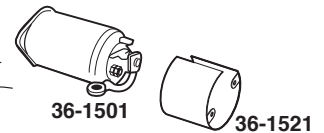
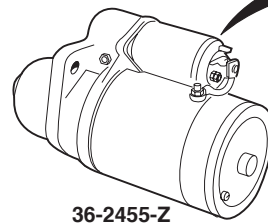

MT = Manual Transmission
AT = Automatic Transmission

Core Refund Information - Starter: A rebuildable core will have no excessive wear. No damage due to force, fire, water, acid or corrosion. No disassembled cores. If it does not meet the above standards, it is not rebuildable and will not be refunded. DO NOT send a non-rebuildable core.

PART	DESCRIPTION AND APPLICATION	REQD	LIST	SELL
6 Cylinder Engines				
36-2455-Z	STARTER \$10 CORE MT 250 BLZ JIM	73-74 (1)	74.94	59.95
36-2450-Z	STARTER \$10 CORE AT 250 BLZ JIM	73-74 (1)	74.94	59.95
36-2455-Z	STARTER \$10 CORE 250 BLZ JIM	75-81 (1)	74.94	59.95
36-2459-Z	STARTER \$10 CORE 250 BLZ JIM	82 (1)	87.44	69.95
V8 Engines				
36-2455-Z	STARTER \$10 CORE 305 BLZ JIM	77-80 (1)	74.94	59.95
36-2461-Z	STARTER \$10 CORE 305 BLZ JIM	81 (1)	87.44	69.95
36-2460-Z	STARTER \$20 CORE 2WD 305 BLZ JIM	82 (1)	87.44	69.95
36-2458-Z	STARTER \$20 CORE 4WD 305 BLZ JIM	82 (1)	87.44	69.95
36-2460-Z	STARTER \$20 CORE 305F BLZ JIM	83 (1)	87.44	69.95
36-2461-Z	STARTER \$10 CORE 2WD 305H BLZ JIM	83 (1)	87.44	69.95
36-2458-Z	STARTER \$20 CORE 4WD 305H BLZ JIM	83 (1)	87.44	69.95
36-2458-Z	STARTER \$20 CORE AT W/4WD 305 BLZ JIM	84 (1)	87.44	69.95
36-2462-Z	STARTER \$15 CORE AT W/O 4WD 305 BLZ JIM	84 (1)	87.44	69.95
36-2460-Z	STARTER \$20 CORE "A" 2WD 305 BLZ JIM	85 (1)	87.44	69.95
36-2462-Z	STARTER \$15 CORE "B" 2WD 305 BLZ JIM	85 (1)	87.44	69.95
36-2458-Z	STARTER \$20 CORE 4WD 305 BLZ JIM	85 (1)	87.44	69.95
36-2458-Z	STARTER \$20 CORE AT W/4WD 305 BLZ JIM	86-87 (1)	87.44	69.95
36-2460-Z	STARTER \$20 CORE AT W/O 4WD 305 BLZ JIM	86-87 (1)	87.44	69.95
36-2450-Z	STARTER \$10 CORE 307 BLZ JIM	73 (1)	74.94	59.95
36-2455-Z	STARTER \$10 CORE 350 BLZ JIM	73-74 (1)	74.94	59.95
36-2463-Z	STARTER \$20 CORE 350 BLZ JIM	75-81 (1)	87.44	69.95
36-2460-Z	STARTER \$20 CORE 2WD 350L BLZ JIM	82 (1)	87.44	69.95
36-2458-Z	STARTER \$20 CORE 4WD 350L BLZ JIM	82 (1)	87.44	69.95
36-2456-Z	STARTER \$20 CORE MT 2WD 350 BLZ JIM	82 (1)	87.44	69.95
36-2460-Z	STARTER \$20 CORE AT 2WD 350 BLZ JIM	82 (1)	87.44	69.95
36-2458-Z	STARTER \$20 CORE 4WD 350 BLZ JIM	82 (1)	87.44	69.95
36-2458-Z	STARTER \$20 CORE AT W/4WD 350 BLZ JIM	83-91 (1)	87.44	69.95
36-2460-Z	STARTER \$20 CORE AT W/O 4WD 350 BLZ JIM	83-91 (1)	87.44	69.95
36-2465-Z	STARTER \$40 CORE MT 6.2L DIESEL	82-88 (1)	199.94	159.95
36-2466-Z	STARTER \$40 CORE AT 6.2L DIESEL	82-88 (1)	212.44	169.95
36-2468-Z	STARTER \$55 CORE 2WD 6.2L DIESEL	89 (1)	337.44	269.95
36-2467-Z	STARTER \$100CORE MT 4WD 6.2L DIESEL	89 (1)	249.94	199.95
36-2469-Z	STARTER \$55 CORE AT W/4WD 6.2L DIESEL	89 (1)	337.44	269.95
36-2469-Z	STARTER \$55 CORE AT W/4WD 6.2L DIESEL	90-91 (1)	337.44	269.95
36-2468-Z	STARTER \$55 CORE AT W/O 4WD 6.2L DIESEL	90-91 (1)	337.44	269.95
36-2463-Z	STARTER \$20 CORE 400 BLZ JIM	75-79 (1)	87.44	69.95

Starter Solenoid and Heat Shield

36-1501	SOLENOID	BLZ JIM	73-81 (1)	24.94	19.95
36-1503	SOLENOID	W/O DSL BLZ JIM	82-91 (1)	24.94	19.95
36-1501	SOLENOID	DSL 2WD BLZ JIM	82-91 (1)	24.94	19.95
36-1501	SOLENOID	DSL 4WD BLZ JIM	82-83 (1)	24.94	19.95
36-1501	SOLENOID	MT DSL 4WD BLZ JIM	84-88 (1)	24.94	19.95
36-1501	SOLENOID	DSL 4WD BLZ JIM	89-91 (1)	24.94	19.95
36-1521	SOLENOID HEAT SHIELD	BLZ JIM	73-91 (1)	12.44	9.95

Note: "A" Case diameter 4-1/4" (108mm).
"B" Case diameter 3-7/8" (98mm).

Wiper Delay Switch



When it is sprinkling or drizzling outside, there is no need for your windshield wipers to work constantly. That's why you need a Wiper Delay Switch. Stop the annoying sound of your wiper blades scraping across your windshield. Buy this Wiper Delay Switch today and rid yourself of that annoying sound.

36-4097	WIPER DELAY SWITCH			124.94	99.95
---------	--------------------	--	--	--------	-------

Windshield Wiper and Washer

Blazer 1973-84
Jimmy 1973-84

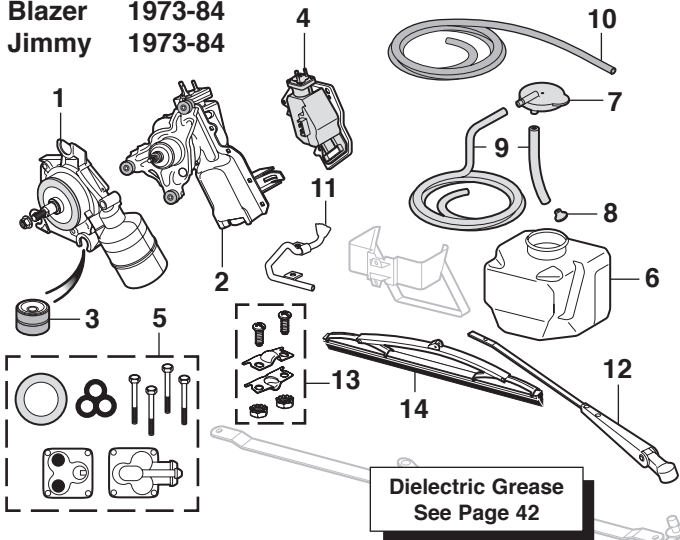

Core Refund Information - Wiper Motors: A rebuildable core will have no excessive wear. No broken, burned, damaged or disassembled units. No stripped, rusted, corroded or water damaged units. If it does not meet the above standards, it is not rebuildable and will not be refunded. DO NOT send a non-rebuildable core.

36-4052-Z	(1) WIPER MOTOR-REMAN	\$15 CORE	BLZ JIM	73-77	(1)	112.44	89.95
36-4054-Z	(2) WIPER MOTOR-REMAN W/PUMP	\$15 CORE	BLZ JIM	78-84	(1)	124.94	99.95
30-1160	(3) GROMMET-WIPER MOTOR		BLZ JIM	73-84	(3)	4.31	3.45
36-4078	(4) WASHER PUMP		BLZ JIM	73-80	(1)	37.44	29.95
36-4082	(5) WASHER PUMP REPAIR KIT		BLZ JIM	73-84	(1)	12.44	9.95
36-4091	(6) WASHER JAR		BLZ JIM	73-75	(1)	12.44	9.95
36-4092	(6) WASHER JAR		BLZ JIM	76-84	(1)	24.94	19.95
36-4095	(7) CAP-WASHER JAR		BLZ JIM	73-84	(1)	3.69	2.95
30-1990	(8) FILTER		BLZ JIM	81-84	(1)	3.69	2.95
36-4070	(9) HOSE-JAR TO PUMP-9 FT		BLZ JIM	73-84	(1)	4.94	3.95
36-4071	(10) HOSE-PUMP TO NOZZLE-12 FT		BLZ JIM	73-84	(1)	6.19	4.95
30-1423	(11) WASHER NOZZLE		BLZ JIM	73-80	(2)	8.69	6.95
30-1424	(11) WASHER NOZZLE		BLZ JIM	81-84	(2)	8.69	6.95
36-4040	(12) WIPER ARM-SILVER		BLZ JIM	73-84	(2)	21.19	16.95
36-4041	(12) WIPER ARM-BLACK		BLZ JIM	73-84	(2)	22.44	17.95
36-4001	(13) WIPER LINK REPAIR KIT		BLZ JIM	73-84	(1)	6.19	4.95
36-4012	(14) WIPER BLADE		BLZ JIM	73-84	(2)	12.44	9.95

Windshield Wiper and Washer

Blazer 1985-91
Jimmy 1985-91

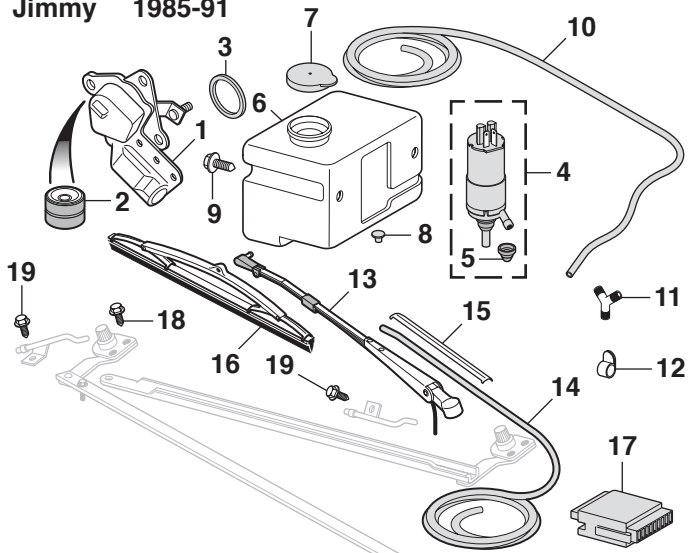

36-4055-Z	(1) WIPER MOTOR-REMAN	\$30 CORE	BLZ JIM	85-91	(1)	124.94	99.95
30-1160	(2) GROMMET-WIPER MOTOR		BLZ JIM	85-91	(3)	4.31	3.45
30-2304	(3) GASKET		BLZ JIM	85-91	(1)	7.44	5.95
36-4084	(4) WASHER PUMP		BLZ JIM	85-91	(1)	24.94	19.95
30-1286	(5) GROMMET-PUMP		BLZ JIM	85-91	(1)	1.19	.95
36-4094	(6) WASHER JAR		BLZ JIM	85-91	(1)	37.44	29.95
36-4096	(7) CAP-WASHER JAR		BLZ JIM	85-91	(1)	4.94	3.95
30-1990	(8) FILTER		BLZ JIM	85-91	(1)	3.69	2.95
30-0483	(9) SCREW		BLZ JIM	85-91	(2)	1.19	.95
36-4071	(10) WASHER HOSE-PUMP-12 FT		BLZ JIM	85-91	(1)	6.19	4.95
30-1362	(11) Y-CONNECTOR		BLZ JIM	85-91	(1)	2.44	1.95
30-1363	(12) RETAINER		BLZ JIM	85-91	A/R	1.19	.95
36-4042	(13) WIPER ARM-BLACK		BLZ JIM	85-91	(2)	22.44	17.95
36-4075	(14) WASHER HOSE-WIPER ARM-4 FT		BLZ JIM	85-91	(1)	3.69	2.95
36-4076	(15) WIPER ARM HOSE GUARD		BLZ JIM	85-91	(2)	4.94	3.95
36-4012	(16) WIPER BLADE		BLZ JIM	85-91	(2)	12.44	9.95
36-4098	(17) CONTROL MODULE-WIPER DELAY		BLZ JIM	85-91	(1)	99.94	79.95
30-0331	(18) BOLT		BLZ JIM	85-91	(6)	1.19	.95
30-0454	(19) BOLT		BLZ JIM	85-91	(2)	.38	.30

Universal Washer Pump

This Universal Windshield Washer Pump adapts to any 12 volt truck. It installs in minutes with simple household tools.

It is a gear driven positive replacement pump that ensures a constant spray under all conditions. All necessary parts and instructions are included.

36-4081

36-4081	UNIVERSAL WASHER PUMP	BLZ JIM	73-91	(1)	24.94	19.95
---------	-----------------------	---------	-------	-----	-------	-------

Universal Windshield Washer Nozzle Set

This Universal Windshield Washer Nozzle Set replaces existing hood mounted nozzles, or can be added to the hood for a more effective spray. The kit includes two nozzles, connecting hose and key to adjust the spray. Drilling and extra hose are required on trucks not originally equipped with hood mounted washer nozzles. Upgrade or replace your old washer nozzles with this Universal Windshield Washer Nozzle Set today!

36-4099

36-4099	WINDSHIELD WASHER NOZZLE SET	BLZ JIM	73-91	(1)	12.44	9.95
---------	------------------------------	---------	-------	-----	-------	------

Universal Windshield Washer Kit

The kit includes:

- 1 Washer bottle with attached cap
- 1 Washer pump
- 7-1/2 feet of washer hose
- Push-button switch with wire harness
- Washer nozzles
- T-connector
- Mounting brackets with hardware

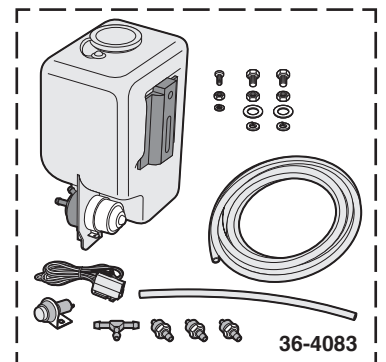

36-4083

This Universal Windshield Washer Kit includes everything you need to replace your worn or broken windshield washer system and will adapt to any 12V truck.

The washer bottle holds 1.5L of washer fluid. Fluid levels can easily be read without removing the cap.

36-4083	WINDSHIELD WASHER KIT	BLZ JIM	73-91	(1)	24.94	19.95
---------	-----------------------	---------	-------	-----	-------	-------

Electronic Musical Horn with 46 Sounds and PA



38-1503

The Electronic Musical Horn easily plugs into a cigarette lighter or power point to play a selected sound three times and stop automatically or can be used as a powerful loud speaker with the included microphone. Auxiliary input allows you to play music from your MP3 player or iPod. The command module is 7" wide by 3" high and easily mounts within reach using the included adhesive backed hook and loop patches. No drilling is required.

Features include an adjustable rotary on/off volume control to allow for easy sound level control, five bright LED lights on the control module which instantly indicates system mode and a 4" diameter weatherproof horn that mounts under the hood. For 12 volt negative ground systems.

46 Different Sounds

Animal Mode: Bird, Eagle, Elephant, Horse, Sheep, Dog, Tiger, Cow, Rooster, Turkey, Cat, Duck, Hen, Frog.

Alarm Mode: Whistle, Car Horn, Train, Laughing and 12 different siren sounds.

Music Mode: Lambada, It's A Small World, Fur Elise, Do Re Mi, Oh My Darling, Silent Night, Long Long Ago, Hungary Dance, For Bogey, Swan Lake, Oh Susannah, Baho Dance, Hallelujah, Row Row Row Your Boat, Love Story, When The Saints Go Marching In. Or go directly to Piano Mode and create your own music by pressing the buttons on the control panel.

PART	DESCRIPTION AND APPLICATION	LIST	SELL
38-1503	ELECTRONIC MUSICAL HORN SYSTEM 12 VOLT	62.44	49.95

Horns Make Your Presence Known



Attractive set of Electric Twin Tone Horns. One high toned, the other low toned. Contains relay and mounting bracket.

38-0372

PART	DESCRIPTION AND APPLICATION	LIST	SELL
38-0372	HELLA TWIN TONE HORN SET ALL MODELS	49.94	39.95



Air Horns are powerful enough to get attention over any level of road noise. Contains everything needed for installation.

38-0370

38-0371	HELLA AIR HORN SET-2 TRUMPET	ALL MODELS	74.94	59.95
38-0370	HELLA AIR HORN SET-3 TRUMPET	ALL MODELS	74.94	59.95

Replacement Horns

Blazer 1973-91
Jimmy 1973-91

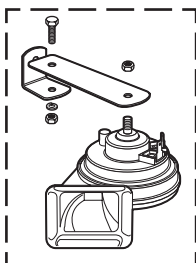

36-2150	HORN UNIT-STANDARD-LOW	BLZ JIM	73-91 (1)	24.94	19.95
36-2152	HORN UNIT-STANDARD-HIGH	BLZ JIM	73-91 (1)	24.94	19.95

Relays and Flashers

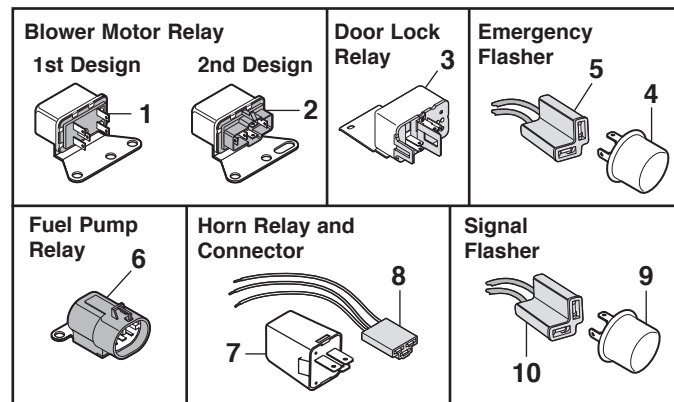

PART	ILL#	DESCRIPTION AND APPLICATION	REQD	LIST	SELL
36-0682	(1)	A/C BLOWER MOTOR RELAY 1ST BLZ JIM	73-78 (1)	16.19	12.95
36-0684	(2)	A/C BLOWER MOTOR RELAY 2ND BLZ JIM	78-82 (1)	16.19	12.95
36-0728		A/C BLOWER MOTOR RELAY	BLZ JIM	83-91 (1)	12.44
36-0750	(3)	DOOR LOCK RELAY	BLZ JIM	77-91 (1)	124.94
36-0650	(4)	EMERGENCY FLASHER-2 PRONG	BLZ JIM	73-91 (1)	4.94
36-0889	(5)	SOCKET-FLASHER	BLZ JIM	73-91 (1)	7.44
36-0729	(6)	FUEL PUMP RELAY	350K BLZ JIM	87 (1)	16.19
36-0625	(7)	HORN RELAY	BLZ JIM	73-91 (1)	11.19
36-0585	(8)	CONNECTOR-HORN RELAY	BLZ JIM	73-91 (1)	3.69
36-0650	(9)	SIGNAL FLASHER-2 PRONG	BLZ JIM	73-91 (1)	4.94
36-0889	(10)	SOCKET-FLASHER	BLZ JIM	73-91 (1)	7.44

Battery Mat

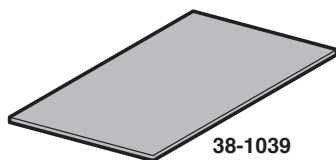

38-1039

This battery mat is made from polypropylene needlepunch felt, a rugged space age product. Its unique construction allows the Battery Mat to trap and contain acid while its powerful neutralizing agents start to work immediately to counterbalance the hazardous effects of the acid. The Battery Mat is safe to handle and takes only minutes to install.

PART	DESCRIPTION	LIST	SELL
38-1039	BATTERY MAT-BLACK-8" X 12"	6.19	4.95

Battery Tap Accessory Circuit Kit

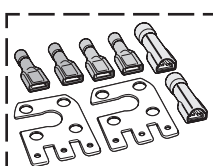

36-0846

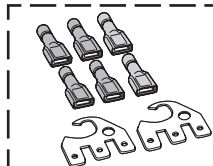

36-0847

Use the Battery Tap as an easy and reliable way to make direct connections at the battery. Designed to fit positive and/or negative battery terminals. Each Battery Tap provides up to three new circuits. Kit contains two taps and six crimp connectors. The Battery Tap can be stacked to provide additional connection points or can be attached to the vehicle frame for additional grounding points.

36-0846	BATTERY TAP KIT-SIDE MOUNT	6.19	4.95
36-0847	BATTERY TAP KIT-TOP POST	6.19	4.95

Battery Terminal Conversion Set

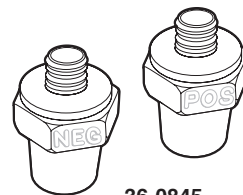

36-0845

Converts a side terminal battery to accept top terminal cables and accessories. Also provides an easy connection for battery charging equipment.

PART	DESCRIPTION	LIST	SELL
36-0845	TERMINAL CONVERSION SET	4.94	3.95

Battery Cables

Blazer 1973-91

Jimmy 1973-91

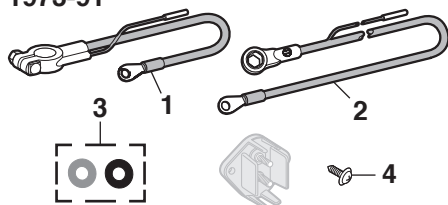

All battery cables are made of a quality copper core that extends to the end of the plated lug to give a one-piece connection.

TP = Top Post

SP = Side Post

AUX = Auxiliary

Part numbers ending in -RD are red cables.

Part numbers ending in -BL are black cables.

PART	ILL#	DESCRIPTION AND APPLICATION	REQD	LIST	SELL
36-2536-RD (1)		POSITIVE CABLE-TP 32"	BLZ JIM 73-91 (1)	12.44	9.95
36-2576-RD		POSITIVE CABLE-TP 35"	BLZ JIM 73-91 (1)	8.69	6.95
36-2533-RD		POSITIVE CABLE-TP 43"	BLZ JIM 73-91 (1)	13.69	10.95
36-2559-RD		POSITIVE CABLE-TP 48"	BLZ JIM 73-91 (1)	9.94	7.95
36-2587-RD		POSITIVE CABLE-TP 48"	BLZ JIM 73-91 (1)	9.94	7.95
36-2537-RD		W/O AUX LEAD POSITIVE CABLE-TP 53"	BLZ JIM 73-91 (1)	12.44	9.95
36-2586-RD		POSITIVE CABLE-TP 56"	BLZ JIM 73-91 (1)	12.44	9.95
36-2538-RD		POSITIVE CABLE-TP 65"	BLZ JIM 73-91 (1)	12.44	9.95
36-2530-BL		NEGATIVE CABLE-TP 25"	BLZ JIM 73-91 (1)	6.19	4.95
36-2531-BL		NEGATIVE CABLE-TP 32"	BLZ JIM 73-91 (1)	7.44	5.95
36-2532-BL		NEGATIVE CABLE-TP 38"	BLZ JIM 73-91 (1)	8.69	6.95
36-2585-BL		NEGATIVE CABLE-TP 53"	BLZ JIM 73-91 (1)	9.94	7.95
36-2566-RD (2)		POSITIVE CABLE-SP 25"	BLZ JIM 73-91 (1)	7.44	5.95
36-2560-RD		POSITIVE CABLE-SP 45"	BLZ JIM 73-91 (1)	9.94	7.95
36-2561-RD		POSITIVE CABLE-SP 50"	BLZ JIM 73-91 (1)	9.94	7.95
36-2564-RD		POSITIVE CABLE-SP 55"	BLZ JIM 73-91 (1)	11.19	8.95
36-2567-RD		POSITIVE CABLE-SP 65"	BLZ JIM 73-91 (1)	12.44	9.95
36-2568-BL		NEGATIVE CABLE-SP 25"	BLZ JIM 73-91 (1)	7.44	5.95
36-2565-BL		NEGATIVE CABLE-SP 30"	BLZ JIM 73-91 (1)	7.44	5.95
36-2562-BL		NEGATIVE CABLE-SP 35"	BLZ JIM 73-91 (1)	8.69	6.95
36-2581-BL		NEGATIVE CABLE-SP 45"	BLZ JIM 73-91 (1)	8.69	6.95
36-2590 (3)		TERMINAL PROTECTOR SET	BLZ JIM 73-91 (1)	2.44	1.95
29-0370 (4)		SCREW	BLZ JIM 73-91 (2)	.31	.25

Battery Disconnect Switches



- Put an end to battery drain
- Effective deterrent against vehicle theft
- Reduced risk of fire while vehicle is parked

Battery Disconnect Switches are easy to install and use. Depending upon the switch, you simply unscrew the knob, lift the lever, or turn the key to isolate the battery from the rest of the electrical system, which reduces the risk of fire while your vehicle is parked. With key or knob style disconnects, the key or knob can be totally removed as an additional deterrent against vehicle theft. A 15-amp Bypass Fuse is available to maintain the settings on your computer, radio, clock, etc., while your battery is disconnected.

PART	DESCRIPTION AND APPLICATION	REQD	LIST	SELL
36-0809	BATTERY DISCONNECT-KNOB STYLE TOP POST	(1)	12.44	9.95
36-0813	BATTERY DISCONNECT-KNIFE STYLE TOP POST	(1)	37.44	29.95
36-0814	BATTERY DISCONNECT-KNOB STYLE SIDE POST	(1)	21.19	16.95
36-0811	BATTERY DISCONNECT-KNIFE STYLE SIDE POST	(1)	37.44	29.95
36-0709	BATTERY DISCONNECT-KEY STYLE IN LINE	(1)	19.94	15.95
36-0909	BYPASS FUSE-15 AMP IN LINE	(1)	4.94	3.95

Battery Tray

Blazer 1973-80

Jimmy 1973-80

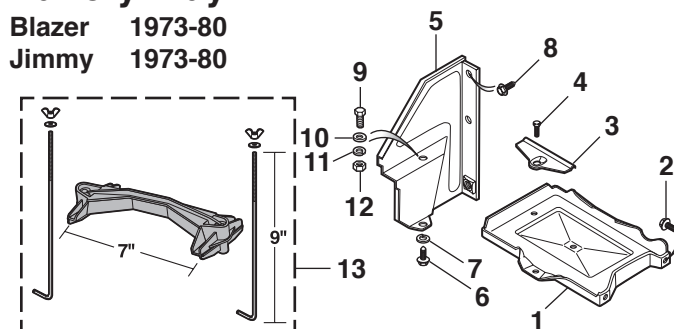

38-6314 (1)	BATTERY TRAY	BLZ JIM 73-80 (1)	16.19	12.95
30-0230 (2)	BOLT-TRAY MOUNT	BLZ JIM 73-80 (2)	1.19	.95
30-3520 (3)	BATTERY CLAMP	BLZ JIM 73-80 (1)	3.69	2.95
30-0211 (4)	BOLT-CLAMP	BLZ JIM 73-80 (1)	1.19	.95
38-6312 (5)	HANGER ASSY-INNER	BLZ JIM 73-80 (1)	24.94	19.95
30-0430 (6)	SCREW	BLZ JIM 73-80 (1)	2.44	1.95
30-0626 (7)	LOCK WASHER	BLZ JIM 73-80 (1)	.44	.35
30-0230 (8)	BOLT	BLZ JIM 73-80 (3)	1.19	.95
30-0288 (9)	BOLT-TRAY/HANGER	BLZ JIM 73-80 (1)	.56	.45
30-0656 (10)	FLAT WASHER-TRAY/HANGER	BLZ JIM 73-80 (1)	.31	.25
30-0626 (11)	LOCK WASHER-TRAY/HANGER	BLZ JIM 73-80 (1)	.44	.35
30-0845 (12)	NUT-TRAY/HANGER	BLZ JIM 73-80 (1)	.81	.65
30-3525 (13)	BATTERY HOLD DOWN-7"	BLZ JIM 73-80 (1)	4.94	3.95

Auxiliary Battery Tray

Blazer 1973-80

Jimmy 1973-80

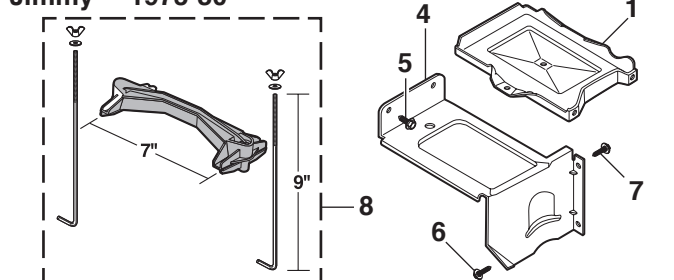

38-6314 (1)	BATTERY TRAY	BLZ JIM 73-80 (1)	16.19	12.95
30-3520 (2)	BATTERY CLAMP	BLZ JIM 73-80 (1)	3.69	2.95
30-0211 (3)	BOLT-CLAMP	BLZ JIM 73-80 (1)	1.19	.95
38-6313 (4)	SUPPORT ASSEMBLY	BLZ JIM 73-80 (1)	31.19	24.95
30-0230 (5)	BOLT	BLZ JIM 73-80 (2)	1.19	.95
30-0430 (6)	BOLT	BLZ JIM 73-80 (1)	2.44	1.95
30-0230 (7)	BOLT	BLZ JIM 73-80 (2)	1.19	.95
30-3525 (8)	BATTERY HOLD DOWN-7"	BLZ JIM 73-80 (1)	4.94	3.95

Battery Tray

Blazer 1981-91

Jimmy 1981-91

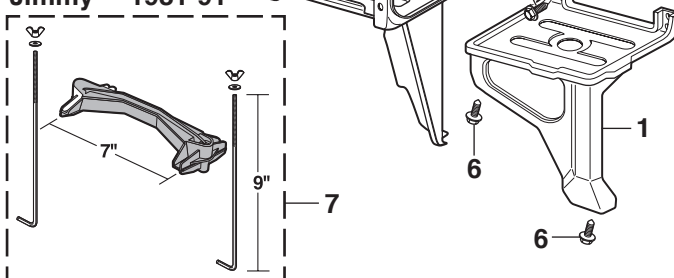

38-6318 (1)	BATTERY TRAY-LH	BLZ JIM 81-89 (1)	74.94	59.95
38-6319 (2)	BATTERY TRAY-RH	BLZ JIM 81-91 (1)	74.94	59.95
30-0230 (3)	BOLT	BLZ JIM 81-91 (2)	1.19	.95
30-0321 (4)	BOLT-HOLD DOWN	BLZ JIM 81-91 (1)	1.19	.95
38-6360 (5)	RETAINER-HOLD DOWN	BLZ JIM 81-91 (1)	3.69	2.95
30-0323 (6)	BOLT	BLZ JIM 81-91 (2)	1.19	.95
30-3525 (7)	BATTERY HOLD DOWN-7"	BLZ JIM 81-91 (1)	4.94	3.95

A/C Select

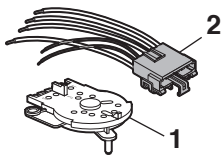

Backup Light and Neutral Safety

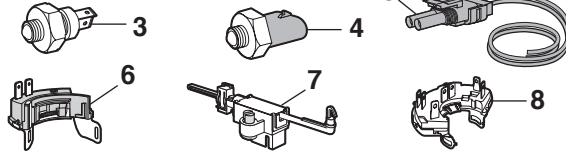

Clutch Pedal Position

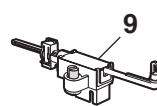

Courtesy Light

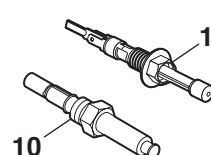

Door Lock



Available Again

Headlight Dimmer

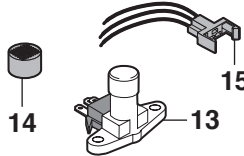

Headlight

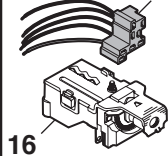

Heater

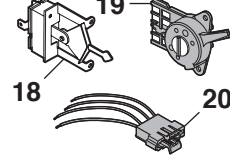

Ignition Lock Cylinder

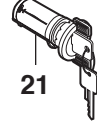

Ignition

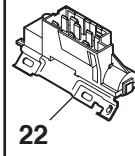

Stop Lamp

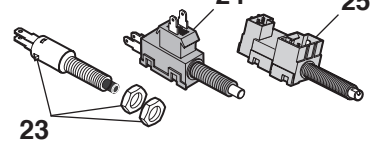

Thermal Limiter

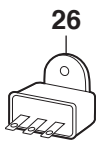

Torque Converter and Cruise Control Release

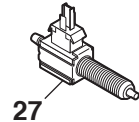

Turn Signal

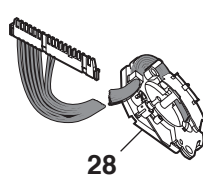

Turn Signal Lever

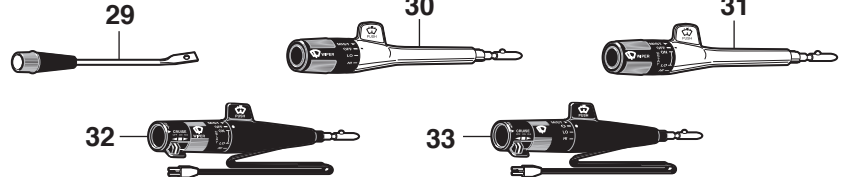

Windshield Wiper

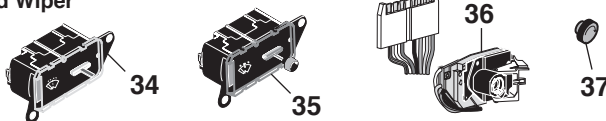

Window

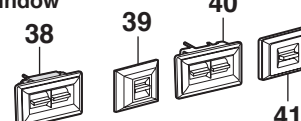

Dielectric Grease
See Page 42

Dashboard Components
See Pages 37-38 & 94-99

PART	ILL#	DESCRIPTION AND APPLICATION	REQD	LIST	SELL
36-0768	(1)	A/C ROTARY SELECT SWITCH	BLZ JIM	83-91 (1)	37.44 29.95
36-0589	(2)	CONNECTOR-ROTARY	BLZ JIM	83-91 (1)	56.19 44.95
36-0660	(3)	BACKUP LIGHT	MANUAL 4SPD BLZ JIM	73-80 (1)	12.44 9.95
36-0663	(4)	BACKUP LIGHT	MANUAL 4SPD BLZ JIM	81-91 (1)	12.44 9.95
36-0578	(5)	CONNECTOR	MANUAL 4SPD BLZ JIM	81-91 (1)	6.19 4.95
36-0665	(6)	BACKUP LIGHT	MANUAL 3SPD BLZ JIM	73-82 (1)	43.69 34.95
36-0592	(7)	NEUTRAL SAFETY	MANUAL BLZ JIM	85-91 (1)	12.44 9.95
36-0629	(8)	BACKUP & NEUTRAL	AUTOMATIC BLZ JIM	73-75 (1)	22.44 17.95
36-0631		BACKUP & NEUTRAL	AUTOMATIC BLZ JIM	76-80 (1)	18.69 14.95
36-0639		BACKUP & NEUTRAL	AUTOMATIC BLZ JIM	81-91 (1)	12.44 9.95
36-0592	(9)	CLUTCH PDL POSITION SWITCH	3SPD 4SPD BLZ JIM	85-91 (1)	12.44 9.95
36-0622	(10)	COURTESY LIGHT SWITCH	BLZ JIM	73-84 (2)	6.19 4.95
36-0623		COURTESY LIGHT SWITCH	BLZ JIM	85-89 (2)	6.19 4.95
36-0712	(11)	COURTESY LIGHT SWITCH	BLZ JIM	90-91 (2)	5.56 4.45
36-0740	(12)	DOOR LOCK SWITCH	BLZ JIM	77-78 (2)	99.94 79.95
36-0742		DOOR LOCK SWITCH	BLZ JIM	82-91 (2)	18.69 14.95
36-0620	(13)	HEADLIGHT DIMMER-FLOOR	BLZ JIM	73-83 (1)	6.19 4.95
36-0621		HEADLIGHT DIMMER-COLUMN	BLZ JIM	84-91 (1)	12.44 9.95
30-2200	(14)	PAD-DIMMER SWITCH	BLZ JIM	73-83 (1)	4.94 3.95
36-0581	(15)	CONNECTOR-DIMMER SWITCH	BLZ JIM	73-91 (1)	2.44 1.95
36-0627	(16)	HEADLIGHT SWITCH	BLZ JIM	73-91 (1)	21.19 16.95
36-0582	(17)	CONNECTOR-HEADLIGHT	BLZ JIM	73-91 (1)	3.69 2.95
36-0677	(18)	HEATER SWITCH	W/O AC BLZ JIM	73-82 (1)	16.19 12.95
36-0678		HEATER SWITCH	W/AC BLZ JIM	73-82 (1)	18.69 14.95
36-0679	(19)	HEATER SWITCH	BLZ JIM	83 (1)	16.19 12.95
36-0681		HEATER SWITCH	BLZ JIM	84-91 (1)	16.19 12.95
36-0587	(20)	CONNECTOR-HEATER SWITCH	BLZ JIM	83-91 (1)	31.19 24.95
36-0651	(21)	IGN LOCK CYL	W/KEYS BLZ JIM	73-77 (1)	24.94 19.95
36-0651		IGN LOCK CYL	W/KEYS "A" BLZ JIM	78 (1)	24.94 19.95
36-0652		IGN LOCK CYL	W/KEYS "B" CHROME	78 (1)	24.94 19.95
29-8162		IGN LOCK CYL	W/KEYS "B" BLACK	78 (1)	24.94 19.95
36-0652		IGN LOCK CYL	W/KEYS CHROME	79-91 (1)	24.94 19.95
29-8162		IGN LOCK CYL	W/KEYS BLACK	79-91 (1)	24.94 19.95
36-0645	(22)	IGNITION SWITCH	W/O TILT BLZ JIM	73-91 (1)	18.69 14.95
36-0647		IGNITION SWITCH	W/TILT BLZ JIM	73-91 (1)	18.69 14.95

PART	ILL#	DESCRIPTION AND APPLICATION	REQD	LIST	SELL
36-0642	(23)	STOP LAMP SWITCH	"C" BLZ JIM	73-79 (1)	6.19 4.95
36-0643		STOP LAMP SWITCH-AT	"C" BLZ JIM	80-89 (1)	8.69 6.95
36-0642		STOP LAMP SWITCH-MT	"C" BLZ JIM	80-89 (1)	6.19 4.95
36-0644	(24)	STOP LAMP SWITCH	"D" BLZ JIM	73-89 (1)	8.69 6.95
36-0713	(25)	STOP LAMP SWITCH	"C" BLZ JIM	90-91 (1)	12.44 9.95
36-0714		STOP LAMP SWITCH	"D" BLZ JIM	90-91 (1)	12.44 9.95
36-0648	(26)	THERMAL LIMITER SWITCH	BLZ JIM	73 (1)	6.19 4.95
36-0006	(27)	TORQUE CONVERTER & CRUISE CNTRL RELEASE SWITCH	BLZ JIM	81-87 (1)	31.19 24.95
36-0568	(28)	TURN SIGNAL SWITCH	BLZ JIM	73-76 (1)	49.94 39.95
36-0615		TURN SIGNAL SWITCH	BLZ JIM	77-83 (1)	37.44 29.95
36-0616		TURN SIGNAL SWITCH	BLZ JIM	84-91 (1)	37.44 29.95
34-0792	(29)	TURN SIGNAL LEVER	"C" BLZ JIM	73-83 (1)	34.94 27.95
34-0794	(30)	TURN SIGNAL LVR-CHROME"C"E"	BLZ JIM	84-90 (1)	62.44 49.95
34-0795		TURN SIGNAL LVR-BLACK "C"E"	BLZ JIM	84-88 (1)	62.44 49.95
34-0796	(31)	TURN SIGNAL LVR-CHROME"C"F"	BLZ JIM	84-91 (1)	24.94 19.95
34-0797		TURN SIGNAL LVR-BLACK "C"F"	BLZ JIM	84-88 (1)	24.94 19.95
34-0784	(32)	TURN SIGNAL LVR-BLACK "D"E"	BLZ JIM	84-90 (1)	49.94 39.95
34-0785	(33)	TURN SIGNAL LVR-BLACK "D"F"	BLZ JIM	84-91 (1)	49.94 39.95
34-0799		TURN SIGNAL LVR-CHROME"D"F"	BLZ JIM	84-91 (1)	87.44 69.95
36-0669	(34)	WIPER SWITCH	"E" BLZ JIM	78-83 (1)	24.94 19.95
36-0671	(35)	WIPER SWITCH	"F" BLZ JIM	78-83 (1)	37.44 29.95
36-0658	(36)	WIPER SWITCH	W/TILT "F" BLZ JIM	84-87 (1)	99.94 79.95
36-0657		WIPER SWITCH	W/O TILT "F" BLZ JIM	84-87 (1)	199.94 159.95
36-0715		WIPER SWITCH	W/TILT "F" BLZ JIM	88-91 (1)	187.44 149.95
36-0716		WIPER SWITCH	W/O TILT "F" BLZ JIM	88-91 (1)	87.44 69.95
30-2621	(37)	KNOB-WIPER SWITCH	"F" BLZ JIM	79-83 (1)	16.19 12.95
36-0754	(38)	POWER WINDOW SWITCH-LH	BLZ JIM	77-81 (1)	87.44 69.95
36-0755	(39)	POWER WINDOW SWITCH-RH	BLZ JIM	77-81 (1)	24.94 19.95
36-0756	(40)	POWER WINDOW SWITCH-LH	BLZ JIM	82-91 (1)	24.94 19.95
36-0757	(41)	POWER WINDOW SWITCH-RH	BLZ JIM	82-91 (1)	24.94 19.95

Note: "E" Models without intermittent wipers.
"F" Models with intermittent wipers.

Note: "A" Lock cylinder does not have a slot for a retaining screw.
"B" Lock cylinder has a slot for a retaining screw.
"C" Without cruise control.
"D" With cruise control.

Universal Wiring Harness ... Finish the Job Right the First Time

Universal Wiring Harness is a comprehensive approach to rewiring your truck's electrical system. This factory assembled harness features a prewired fuse block with the benefit of modern blade type fuses. Adding extra electrical accessories is easy with the built-in additional circuits. Wiring Harnesses are available in 13 circuit and 20 circuit assemblies.

Only the highest quality terminals and GXL/XLPE wire (cross-linked polyethylene, -60°F to 275°F abrasion resistant) is used that is color coded and labeled every 2" to 3". Includes conventional, GM SI internal regulated and 1-wire alternator leads. Includes HEI distributor wiring and GM column mounted ignition switch connectors. Headlight and floor mounted dimmer switches included. Terminals are also provided to make adapting to any aftermarket steering column easier. Standard features include starter wiring, tachometer lead, single headlight plugs, third brake light, horn relay, turn signal and 4-way hazard flashers, fuses, terminal ends and wire ties. Easy-to-follow instructions and schematics are included.



36-3662

Wiring Harness is designed for single headlight systems only. Can be adapted for use on dual headlight models with additional wire and original sockets.

13 Circuit Wiring Harness

- 2 Accessory
- Air Conditioning/Heat
- Brake/Courtesy Lights
- CB Radio
- Cooling Fan
- Gauges/Instruments
- Hazard
- Headlights
- Parklights
- Radio
- Turn Signal
- Wiper

PART	DESCRIPTION AND APPLICATION	REQD	LIST	SELL
36-3662	WIRE HARNESS KIT-13 CIRCUIT "A" BLZ JIM	73-91 (1)	449.94	359.95

20 Circuit Wiring Harness

Includes all of the features of the 13 Circuit Harness plus:

- Clock/Lighter
- Cruise Control
- Dash Lights
- Fuel Pump
- Power Locks
- Power Seats
- Power Windows

36-3663	WIRE HARNESS KIT-20 CIRCUIT "A" BLZ JIM	73-91 (1)	499.94	399.95
---------	---	-----------	--------	--------

Note: "A" For use on carbureted models only.

12 Circuit Fuse Center Connects to Your Existing Wiring

Now a quality 12 circuit pre-wired fuse block is available for connection to your existing vehicle wiring or for use as a starting point for custom wiring.

Features include blade-type fuses, flasher, horn relay and a large selection of terminal ends. Compact size for ease of mounting; measures just 4-1/2" x 5". It also has an anti-theft feature that allows you to simply remove the coil wire fuse from the fuse block to deter vehicle theft.

This factory assembled and completely terminated fuse block includes wiring provisions for:

- Air Conditioning/Heat
- Brake Lights
- Coil (anti-theft feature)
- Dome Light
- Electric Fan
- Emergency Flasher
- Gauges/Dash Instruments
- Headlights
- Horn
- Radio (ignition hot)
- Turn Signals
- Wipers



36-3609

Easy-to-follow instructions are included. Call or go online and order yours today.

36-3609	12 CIRCUIT FUSE CENTER	249.94	199.95
---------	------------------------	--------	--------

CirKit Boss Fuse Center

CirKit Boss Fuse Center provides the ideal cost-effective solution when additional electrical circuits



36-3611

are required or accessory equipment requires ignition hot and constant hot capabilities. It is the only add-on fuse center available in the marketplace with ignition hot capabilities. This safety feature ensures that your add-on circuits will only work if the ignition key is on. This 3 circuit center features two ignition hot circuits and one constant hot circuit. Call or go online and order yours today!

PART	DESCRIPTION	LIST	SELL
36-3611	CIRKIT BOSS FUSE CENTER	74.94	59.95

Interior Light Fader



36-3570

Give yourself a few seconds once you enter your vehicle at night. This Interior Light Fader will turn on your courtesy lights once you open your door and will fade them out within 8 seconds. Measuring 3" x 1-1/2", it can easily be mounted almost anywhere. Easy-to-follow instructions included. Call or go online and get yours today.

PART	DESCRIPTION	LIST	SELL
36-3570	INTERIOR LIGHT FADER	43.69	34.95

Jamb-Tac Wireless Door Jamb Connector

No more running wires through door jambs when installing your stereo radio system, power windows or power door locks. Features solid brass contacts. (Opening the door breaks contact and shuts off connected speakers or power to the power window or door lock.)



36-3607

Adjustable from 1/4" to 11/16". Mounts anywhere on the door jamb. Fully insulated and supplied with all required connectors. Easy-to-follow installation instructions are included.

36-3607	JAMB-TAC	A/R	62.44	49.95
---------	----------	-----	-------	-------

12-Volt Accessory Power Outlet Kit

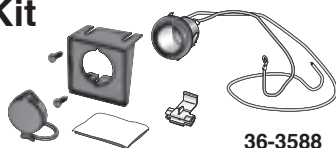

36-3588

Use this Accessory Power Outlet Kit to power any 12-volt accessory. Mounts easily under the dash with the included mounting bracket or installs into any 1-1/8" hole. Kit includes power outlet, cap and mounting hardware.

PART	DESCRIPTION AND APPLICATION	LIST	SELL
36-3588	ACCESSORY POWER OUTLET-12V	12.44	9.95

Split Braid Flex Loom

Unique black flexible braided construction features a 25% edge overlap that will allow for the sharpest of bends without distorting or splitting open. Lateral split design of the flex loom allows for easy installation of multiple wires. Self-wrapping feature ensures the flex loom will return to its original size and shape without the need to use fasteners or tape. Protect your vehicle's wiring, cables, hoses and tubing from unnecessary wear while adding a clean look. Available in three sizes: 1/4", 1/2" or 3/4" diameter.



36-2600	FLEX LOOM 20' L X 1/4" DIA	43.69	34.95
36-2601	FLEX LOOM 10' L X 1/2" DIA	31.19	24.95
36-2602	FLEX LOOM 6' L X 3/4" DIA	24.94	19.95



For More Information on Heavy-Duty Headlight Harness See Page 62