

## Steel Bed Panels

1982-93 Chevy S10

1982-93 GMC S15, Sonoma

**Seam Sealer and Loctite  
Rubberized Undercoating  
See Page 142**

### Steel Body Panels and What to Expect

All sheet metal is inspected before it is shipped and careful steps are taken to package parts so there is no damage during shipping. Due to the nature of the product, sheet metal is easily damaged and scratches, dents, dings and other imperfections are normal and not considered damaged. These kinds of imperfections should be expected and can be easily fixed during installation and the paint preparation, sanding and priming stages of your restoration. It is recommended you inspect all sheet metal that is delivered before the delivery driver leaves. Test fitting of all panels before installation is recommended and the use of alignment shims and other adjustments during the install may be required.

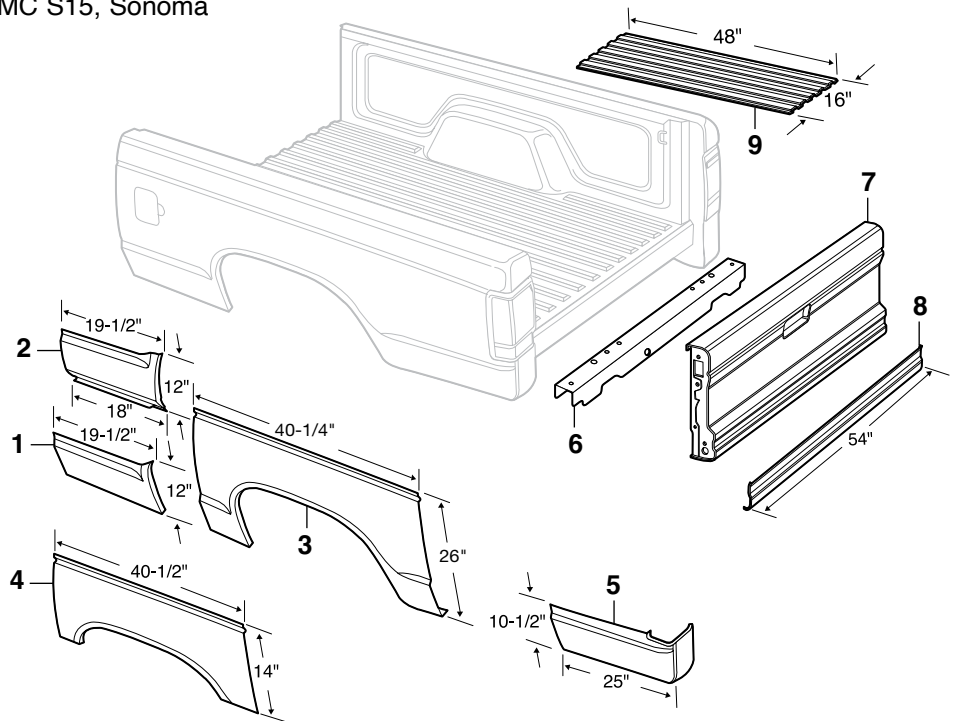

### Left Hand (LH) & Right Hand (RH) Means as You Sit Facing Forward in the Vehicle

PART	ILL#	DESCRIPTION	APPLICATION	REQD	PRICE
29-9658	(1)	LOWER FRONT PANEL-LH	PICKUP	82-93 (1)	\$19.95
29-9659		LOWER FRONT PANEL-RH	PICKUP	82-93 (1)	\$15.45
29-9670	(2)	LWR FRONT PANEL-COMPLETE-LH	SHORTBED	82-93 (1)	\$20.95
29-9671		LWR FRONT PANEL-COMPLETE-RH	SHORTBED	82-93 (1)	\$20.95
29-9650	(3)	EXTENDED WHEEL ARCH-LH	PICKUP	82-93 (1)	\$39.95*
29-9651		EXTENDED WHEEL ARCH-RH	PICKUP	82-93 (1)	\$39.95*
29-9654	(4)	WHEEL ARCH PANEL-LH	PICKUP	82-93 (1)	\$19.95
29-9655		WHEEL ARCH PANEL-RH	PICKUP	82-93 (1)	\$19.95

PART	ILL#	DESCRIPTION	APPLICATION	REQD	PRICE
29-9662	(5)	LOWER REAR PANEL-LH	SHORTBED	82-93 (1)	\$32.95
29-9663		LOWER REAR PANEL-RH	SHORTBED	82-93 (1)	\$32.95
29-9643	(6)	REAR CROSS SILL	PICKUP	82-93 (1)	\$119.95
29-9645	(7)	TAILGATE W/O LETTERING	PICKUP	82-93 (1)	\$114.45*
29-9665	(8)	LOWER TAILGATE PANEL	PICKUP	82-93 (1)	\$36.95
29-9668	(9)	BED REPAIR PANEL 48"x16"	PICKUP	82-93 (AR)	\$29.95

\* Or \*\* after the sell price means your order will incur an Oversize Part Charge for each oversized part. \* Means extra charge will be \$20. \*\* Means extra charge will be \$50. Due to packing and/or transportation requirements, please allow additional time for delivery. Oversized Parts are not available for air delivery.

## Movable Anchor Point



38-3239



These heavy-duty, steel anchor points have a unique "C" clamp design allowing installation where needed; just clamp to bed rail and secure the load. Point and plate are vinyl coated and will not rust or scratch the truck's finish. Can be used with "under the rail" style bed liners.

PART	DESCRIPTION	APPLICATION	REQD	PRICE
38-3239	MOVABLE ANCHOR POINT	FLEETSIDE 82-04	(AR)	\$5.95

## Bedside Attachment Components

1982-93 Chevy S10

1982-93 GMC S15, Sonoma

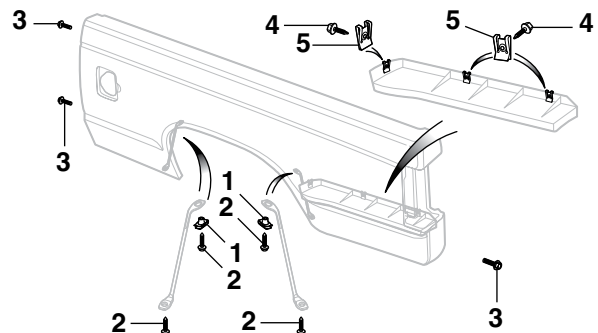

PART	ILL#	DESCRIPTION	APPLICATION	REQD	PRICE
40-0888-C	(1)	U-NUT	PICKUP	82-93 (4)	\$ .95
29-0200	(2)	BOLT	PICKUP	82-93 (8)	\$1.25
29-0215	(3)	BOLT	PICKUP	82-93 (AR)	\$1.35
30-0541	(4)	BOLT	PICKUP	82-93 (6)	\$ .65
30-0829	(5)	U-NUT	PICKUP	82-93 (6)	\$1.25